

7611

STREET WORKOUT



SOCIALIZING



CLIMBING

INFORMATION ABOUT THE PRODUCT

Dimensions	119 x 170 cm
Safety zone	439 x 528 cm
Safety zone area	20 m ²
Overall height	360 cm
Free fall height	250 cm
Product complies with EN 16630:2015-06	YES
Availability of spare parts	YES
According to EN 1176-1:2017-12 norm, the product requires applying a safety surface according to the product's free fall height.	



7611

STREET WORKOUT

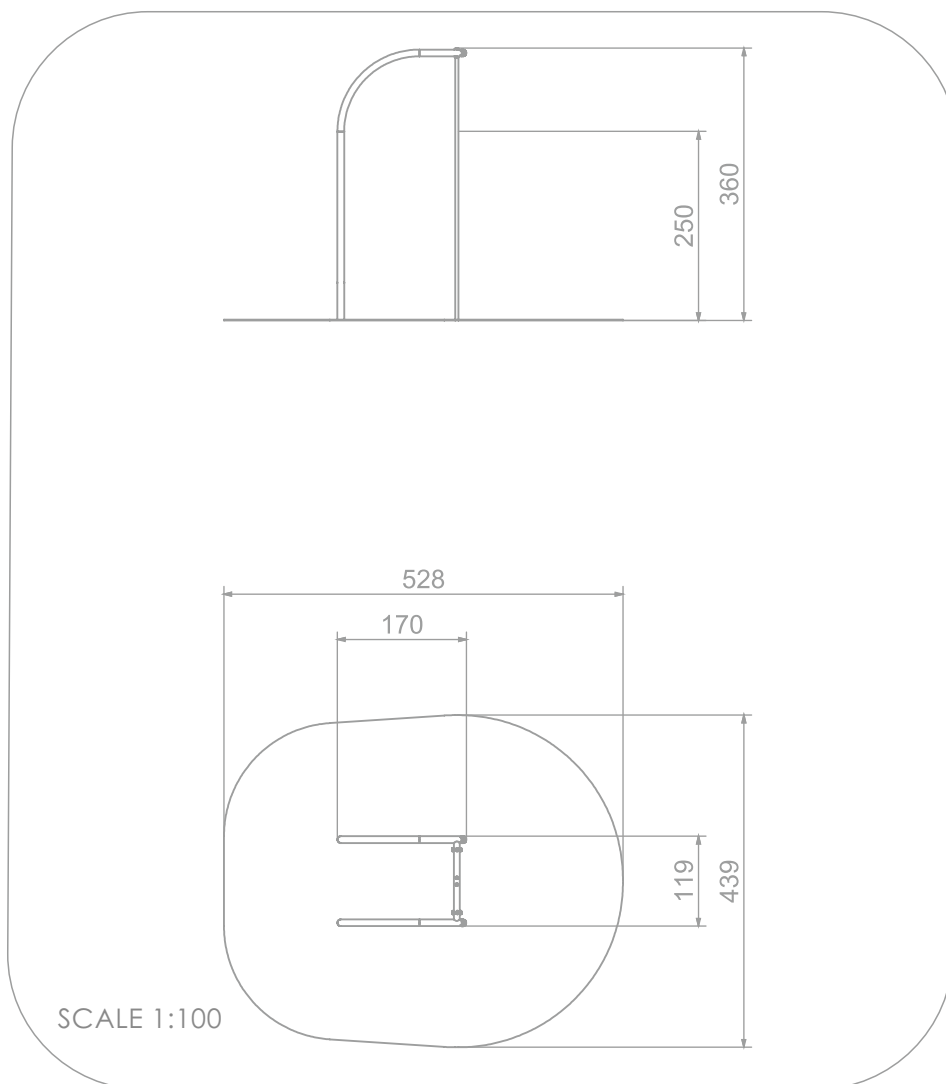

MATERIALS:

SOLID CONSTRUCTION
MADE OF BLACK STEEL
S235JR. CLEANED IN THE
SANDBLASTING PROCESS

POST ENDINGS FINISHED
WITH SOFT EPDM RUBBER

SOLID CONSTRUCTION
MADE OF STAINLESS STEEL
AISI304

