

9072

ACROBAT

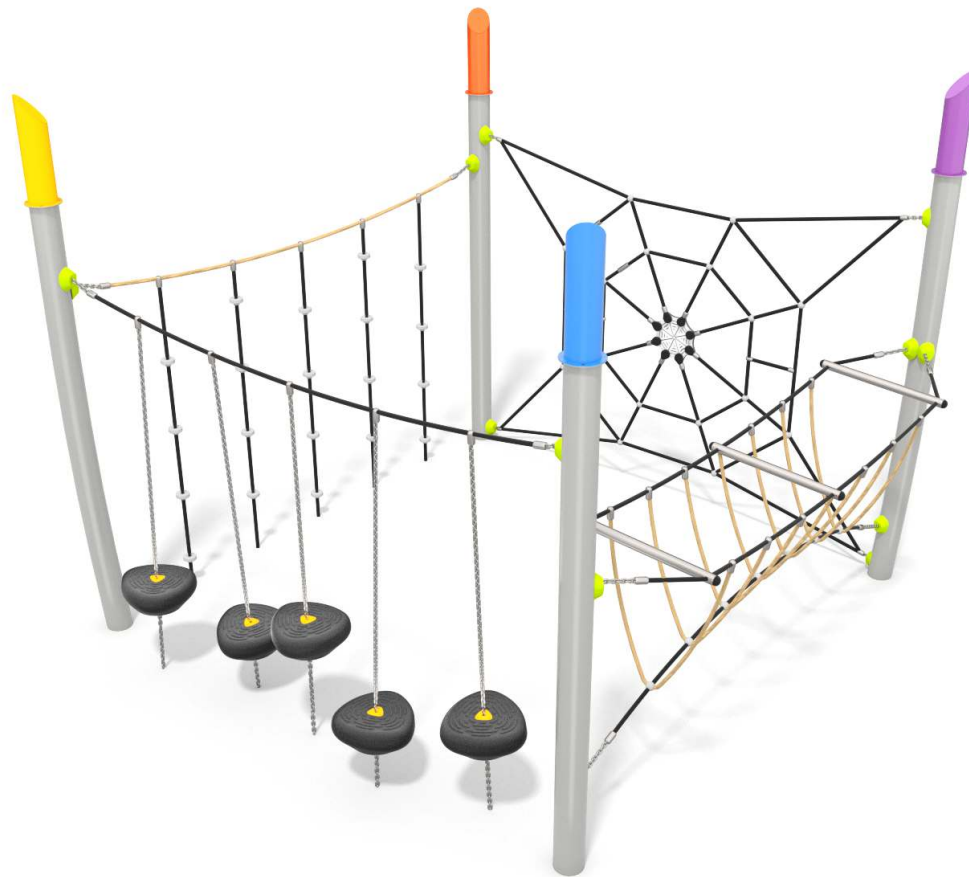

SOCIALIZING



CLIMBING



BALANCING

INFORMATION ABOUT THE PRODUCT

| | |
|---|-------------------|
| Dimensions | 341 x 353 cm |
| Safety zone | 721 x 731 cm |
| Safety zone area | 48 m ² |
| Overall height | 285 cm |
| Free fall height | 222 cm |
| Amount of users | 12 |
| Product complies with EN 1176-1:2017-12 | YES |
| Availability of spare parts | YES |
| Age range | 3-12 |
| According to EN 1176-1:2017 norm, the product requires applying a safety surface according to the product's free fall height. | |

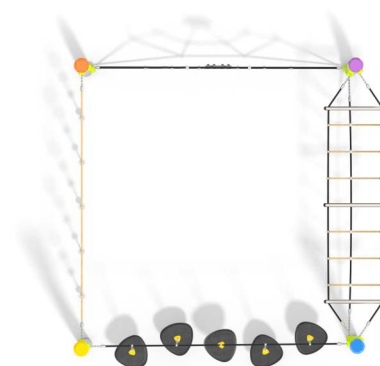

9072

ACROBAT

INFORMATION FOR ARCHITECTS

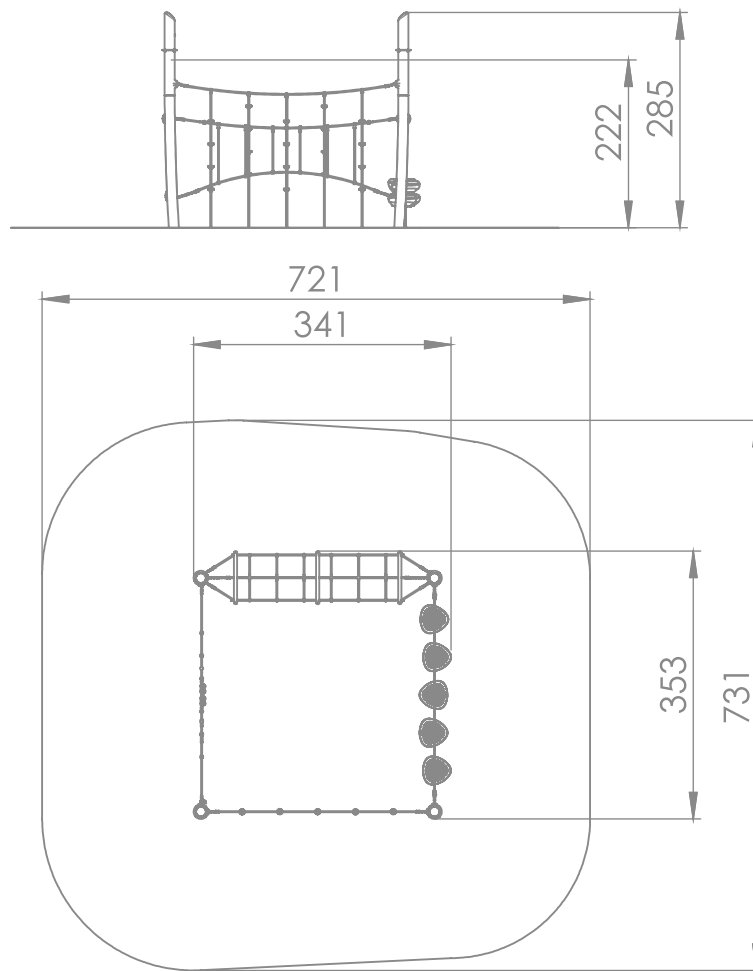

MATERIALS:

| | | | | | |
|--|--|---|---|--|--|
| <p>SOLID CONSTRUCTION MADE OF BLACKSTEEL S235JR. CLEANED IN THE SANDBLASTING PROCESS</p> | <p>ATTESTED 6 MM STAINLESS STEEL CHAINS</p> | <p>ROPE ENDINGS PRESSED IN A SLEEVE MADE OF DURABLE ALUMINUM ALLOY</p> | <p>SOLID AND ESTHETIC ROPE CONNECTORS MADE OF INJECTION MOLDED POLYAMIDE</p> | | |
| | | | | | |
| <p>INNOVATIVE SYSTEM OF CONNECTORS OF STAINLESS STEEL CHAINS WITH POSTS</p> | <p>ROPE LADDER STEPS AND ROPE KNOTS MADE OF INJECTION MOLDED POLYAMIDE</p> | <p>POLYPROPYLENE ROPES PP - MULTISPLIT TYPE WITH A STEEL CORE AND A DIAMETER OF 16 MM</p> | <p>CONNECTING ELEMENTS LIKE SCREWS, NUTS, WASHERS MADE OF STAINLESS STEEL</p> | <p>MODULES MANUFACTURED OF ROTOMOULDED POLYETHYLENE DEVELOP PROWESS AND COORDINATION</p> | |
| | | | | | |

