

# 8002

ECO



SOCIALIZING



CLIMBING



## INFORMATION ABOUT THE PRODUCT

Dimensions	167 x 161 cm
Safety zone	467 x 461 cm
Safety zone area	20 m <sup>2</sup>
Overall height	162 cm
Free fall height	150 cm
Amount of users	10
Product complies with EN 1176-1:2017	YES
Availability of spare parts	YES
Age range	3-12

According to EN 1176-1:2017 norm, the product requires applying a safety surface according to the product's free fall height.



8002

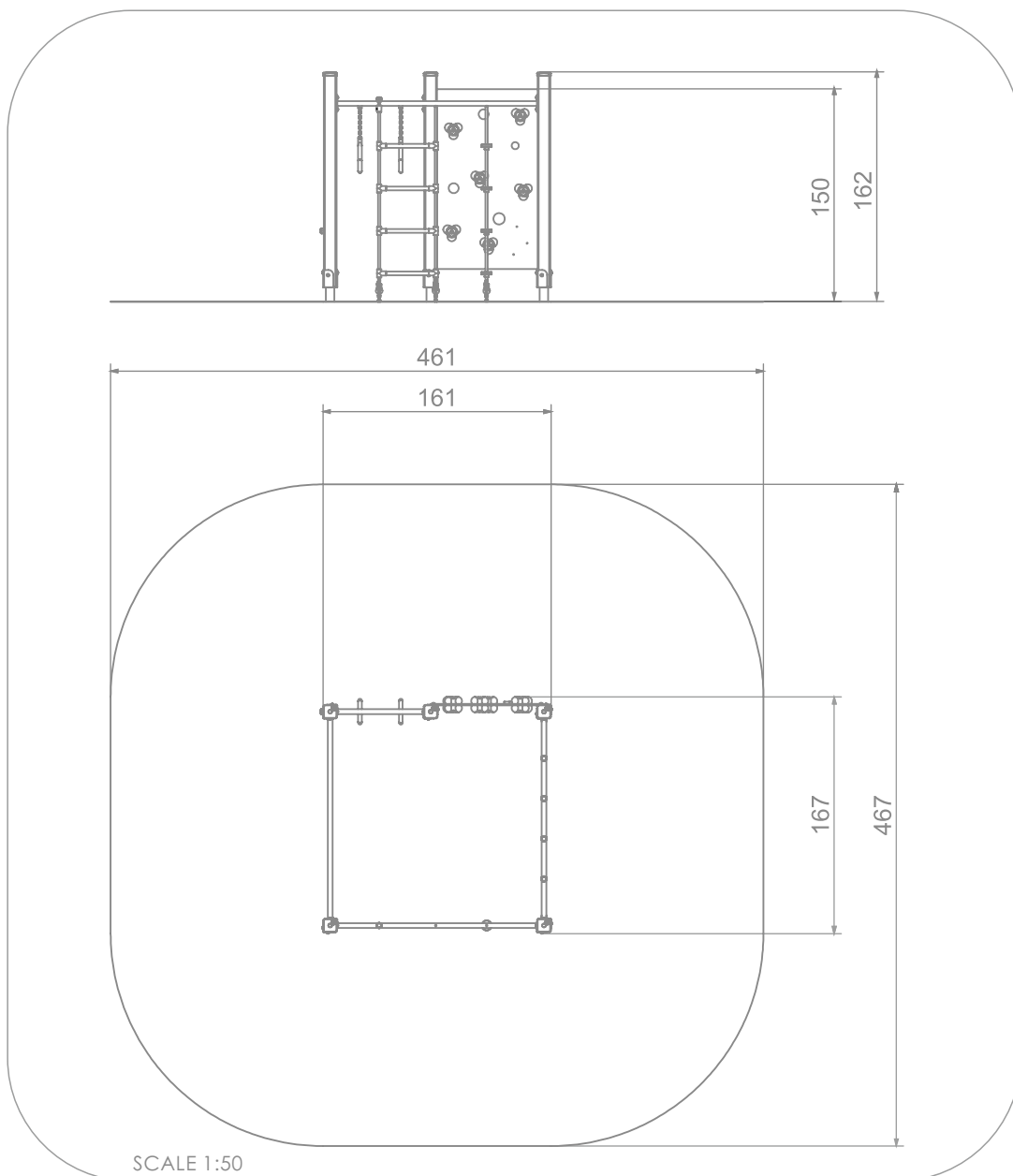

MATERIALS:

SOFT CONIFER WOOD 90 X 90 MM, CORELESS, GLUED IN LAYERS WITH POLYURETHANE GLUES, TOTALLY RESISTANT TO WATER.



WOODEN POSTS ANCHORED TO THE GROUND WITH POWDER GALVANIZED AND POWDER COATED STEEL ANCHORS.



POLIPROPYLENE ROPES PPMULTISPLIT TYPE WITH A STEEL CORE AND A DIMETER OF 16 MM.



ROPE ENDINGS PRESSED IN A SLEEVE MADE OF DURABLE ALUMINIUM ALLOY.



PATENTED SYSTEM OF CONNECTORS AND CLAMPS MADE OF STRONG ALUMINIUM ALLOY.

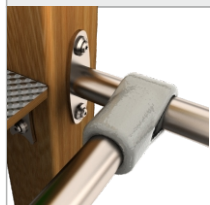

CLIMBING ROCKS MADE OF CHIPPINGS AND COLOURFUL POLYESTER RESIN.



SOLID AND ESTHETIC ROPE CONNECTORS MADE OF INJECTION MOLDED POLYAMIDE.

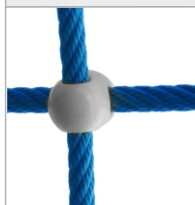

CONNECTING ELEMENTS LIKE SCREWS, NUTS, WASHERS MADE OF STAINLESS STEEL.

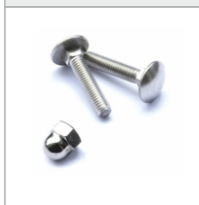

ROPE LADDER KNOTS MADE OF INJECTION MOLDED POLYAMIDE.

