

# 8065

ECO



SOCIALIZING



CLIMBING



SLIDING

## INFORMATION ABOUT THE PRODUCT

Dimensions	470 x 366 cm
Safety zone	771 x 717 cm
Safety zone area	38 m <sup>2</sup>
Overall height	321 cm
Free fall height	152 cm
Amount of users	13
Product complies with EN 1176-1:2017	YES
Availability of spare parts	YES
Age range	3-12
According to EN 1176-1:2017 norm, the product requires applying a safety surface according to the product's free fall height.	



8065

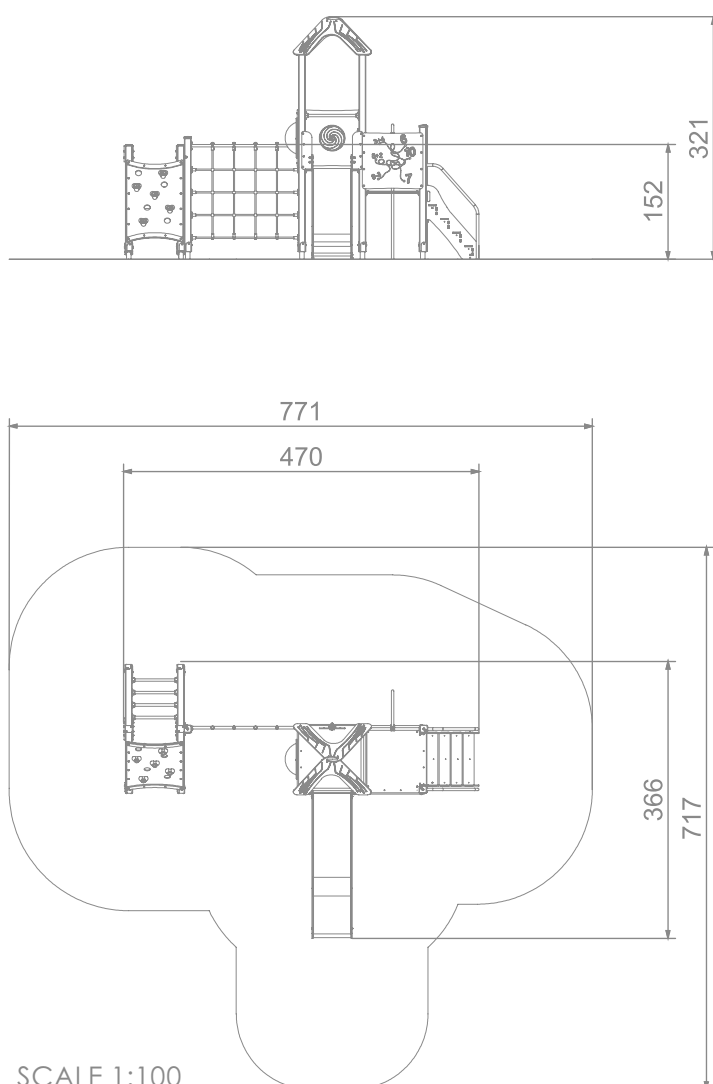
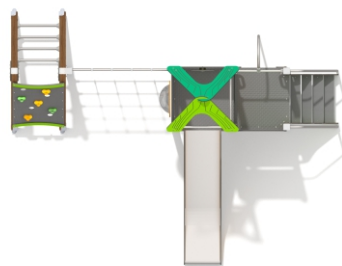

SCALE 1:100

## MATERIALS:

SOFT CONIFER WOOD  
CORELESS, GLUED IN LAYERS  
WITH POLYURETHANE GLUES,  
TOTALLY RESISTANT TO WATER.



WOODEN POSTS  
ANCHORED TO THE  
GROUND WITH POWDER  
GALVANIZED AND  
POWDER COATED STEEL  
ANCHORS.



CONNECTING ELEMENTS  
LIKE SCREWS, NUTS,  
WASHERS MADE OF  
STAINLESS STEEL.

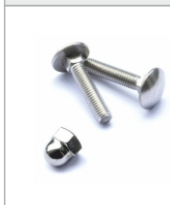

SLIDES MADE OF STAINLESS  
STEEL AISI 304. METAL SHEET  
WITH A THICKNESS OF 2 MM  
FORMED IN A CNC  
TECHNIQUE.



HEMISPHERIC WINDOW  
WITH A DIAMETER  
OF 400 MM.



PATENTED SYSTEM OF  
CONNECTORS AND  
CLAMPS MADE OF  
STRONG ALUMINIUM  
ALLOY.

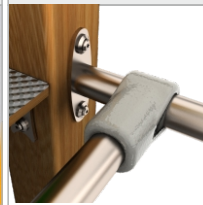

SOLID AND ESTHETIC ROPE  
CONNECTORS MADE OF  
INJECTION MOLDED  
POLYAMIDE.

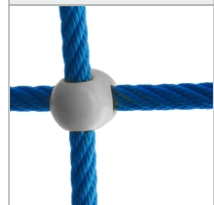

CLIMBING ROCKS MADE  
OF CHIPPINGS AND  
COLOURFUL POLYESTER  
RESIN.

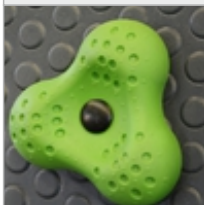

POLYPROPYLENE ROPES  
PP-MULTISPLIT TYPE  
WITH A STEEL CORE AND  
A DIAMETER OF 16 MM.



PLATES OF THE WALLS  
MADE OF COLOURFUL  
TRIPLE LAYERED 15 MM  
HDPE POLYETHYLENE, IN  
THE HIGHEST QUALITY,  
TOTALLY DAMP-PROOF.



SYSTEM OF CONNECTORS  
AND CLAMPS MADE OF  
STRONG ALUMINIUM  
ALLOY.

