

## BENCH 4,50 M WITH 3 FIXED BACKRESTS\*

Ref. 10 9003 EM10 OP00

## BENCH 4,50 M WITH 1 FIXED AND 2 SLIDING BACKRESTS\*

Ref. 10 9021 EM10 OP00



## BENCH 4,50 M WITHOUT BACKREST

Ref. 10 9000 EM10 OP00



## SHORT BENCH 2,50 M

Ref. 10 9100 EM10 OP00



\* Backrest option only available on a 4.50 m long bench

**Available wood :**  
Bosse glue laminated slats,  
without wood stain



**Backrests shades:**  
PMMA  
(polymethyl methacrylate),  
transparent red or grey

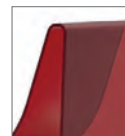

## > Presentation

Sineu Graff has created a bench of a new generation with the German landscape architect Michael Hennemann.

Together, we came up with a sculptural design solution that magnifies both outdoor and indoor spaces.

The wooden body consists of 9 slats, of which 3 descend to the floor to form the leg. Combined with the seat, the leg gives the object a slender look. The seat has sliding or fixed backrests, made of transparent thermoplastic material (polymethyl methacrylate) which give Nine its originality and lightness.

## > Description

The Nine bench is composed of:

- **9 exotic wood slats, class 3, 4500 mm long and 45 mm thick**, of which 6 are 225 mm high and of which 3 are 450 mm high, used as legs
- **44 exotic wood spacers** between the slats
- **12 connecting threaded rods** (not visible)
- **3 legs in painted zinc-plated steel** (on plates with Ø 16 mm hole or to be buried)
- and, depending on the model, **3 fixed backrests made of transparent PMMA** (polymethyl methacrylate) 8 mm thick, and **fixed on steel plates**, to be screwed (drilling and fitting of 4 metal inserts).

Our woods are exclusively collected in sustainably managed forests. Of high quality, they are PEFC labeled for local sourcing, FSC® labeled for exotic hardwoods, or comply with the EUTR (EU Wood Regulations).

**For optimum protection against rust and long-term performance**, the steel elements are zinc coated first, and go through our powder blast process (after having being cleaned and shot-blasted, the parts are coated with a primary layer of epoxy powder, followed by a second layer of polyester powder).

Delivered assembled.

## > Dimensions

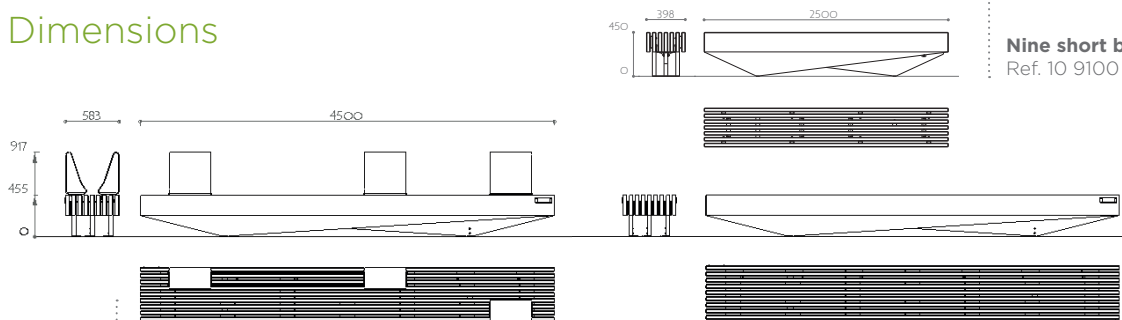

### Nine short bench

Ref. 10 9100 EM10 OP00 - 155 kg

### Nine bench with 3 fixed backrests

Ref. 10 9003 EM10 OP00 - 334 kg

### Nine bench with 1 fixed and 2 sliding backrests

Ref. 10 9021 EM10 OP00 - 334 kg

### Nine bench without backrest

Ref. 10 9000 EM10 OP00 - 310 kg



The mark of responsible forestry



### SEAT

Ref. 10 9110 EM10 OP00



### SEAT WITH SHELF ON THE RIGHT

Ref. 10 9111 EM10 OP00

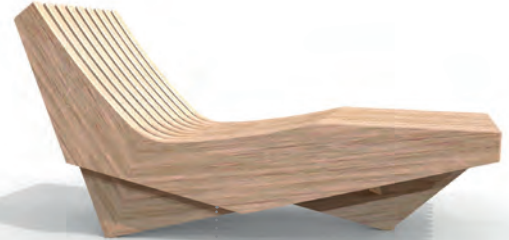

### LOUNGER

Ref. 10 9150 EM10 OP00

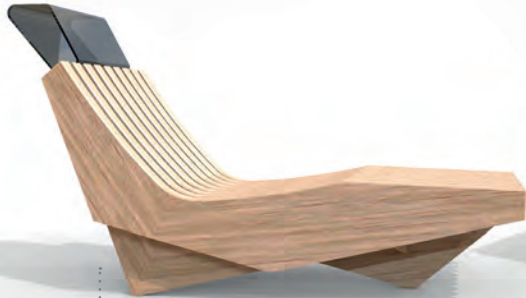

### LOUNGER WITH HEADREST\*

Ref. 10 9155 EM10 OP00

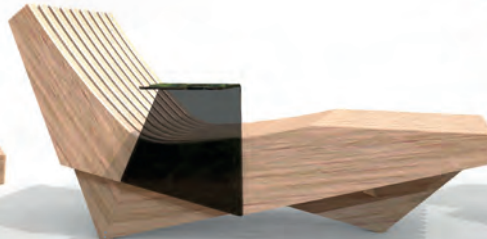

### LOUNGER WITH SHELF ON THE RIGHT

Ref. 10 9151 EM10 OP00

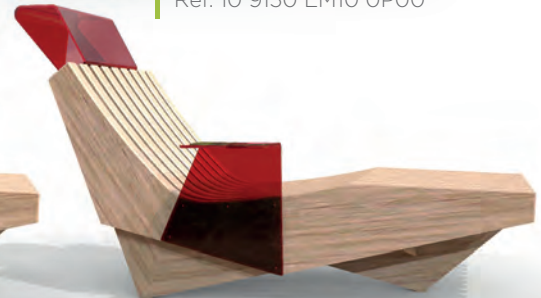

### LOUNGER WITH HEADREST\* & SHELF ON THE RIGHT

Ref. 10 9156 EM10 OP00

\* Headrest option only available on the lounge

#### Available wood :

Bosse glue laminated slats, without wood stain



#### Shelf and headrest shades:

PMMA (polymethyl methacrylate), transparent red or grey

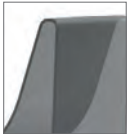
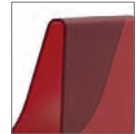

## Description

The Nine seat and lounge are made of:

- **18 pieces of exotic wood**, 38 mm thick
- **2 exotic wood spacers** (fixing the end pieces)
- **1 backrest cover** in exotic wood
- **4 reinforcing pieces for the seat** in zinc and powder coated steel | | **4 reinforcing pieces** for the lounge
- **3 zinc and powder coated steel feet** (on plates with Ø 16 mm hole)
- and, depending on the model, a **shelf integrating a cup holder and/or a headrest made of transparent PMMA** (polymethyl methacrylate), 8 mm thick, to be screwed (drilling and fitting of 4 metal inserts).

Our woods are exclusively collected in sustainably managed forests. Of high quality, they are PEFC labeled for local sourcing, FSC® labeled for exotic hardwoods, or comply with the EUTR (EU Wood Regulations).

**For optimum protection against rust and long-term performance**, the steel elements are zinc coated first, and go through our powder blast process (after having being cleaned and shot-blasted, the parts are coated with a primary layer of epoxy powder, followed by a second layer of polyester powder).

Delivered assembled.

## Dimensions

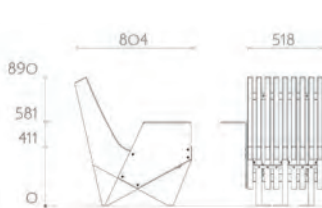

Seat weight (without shelf) : 70 kg

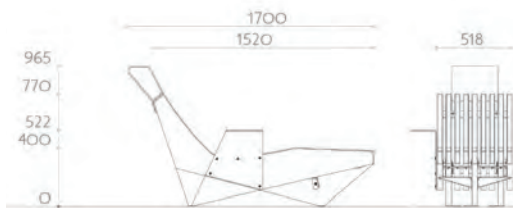

Lounge weight (without shelf and headrest) : 110 kg

